



Kerikeri High School



Nau mai, haere mai ki Te Kura Tuarua o Te Kerikeri.



We are proud of our warm and caring school, where we work hard to serve our diverse and kind-hearted community. We believe strongly in achievement at its highest levels, and in students participating fully in all aspects of school life across the Four Cornerstones of a balanced education

- Academic,
- Sporting,
- Cultural
- Leadership with Service.

Our students become positive, connected and successful and they thrive in our busy environment.

Our school sets and expects high standards, and as a PB4L (Positive Behaviour for Learning) School, we explicitly teach and positively reinforce our expectations and values, in our school expressed by the acronym WAKA:

We are Learners - Whaia te Matauranga
Act with Respect - Manaaki te tangata
Keep Ourselves Safe - Tiaki tangata
Always Proud - Kia manawanui

We enjoy a close and strong connection with our local hapu, Ngāti Rēhia, and we recognise them as kaitiaki of our rohe. We strive to make our school a bicultural setting where all our students feel a sense of whanaungatanga and belonging.

We know that the best learning comes from a close relationship between home and school.

There is something for everyone in our inclusive and rich environment.

We look forward to having you and your child as a part of our school community and we look forward to a positive partnership with your family.

Welcome once, welcome twice, welcome three times to Kerikeri High School.

Mr Mike Clent
Principal



Kerikeri High School

PROSPECTUS

Academic

Sporting

Cultural

Leadership

International

Excellence and Innovation

High Standards

ABOUT US

Uniform and Stationery

Student Bus Transport

Community

Information Technology

Routines

Te Puna Waiora

Wellbeing

Student Enrolment





Academic

Kerikeri High School is committed to providing excellence in education, recognising the individual needs of our students, and to fostering pride among our students and in the community. We offer education to students from Year Seven to Year Thirteen.

Kerikeri High School is accredited by the New Zealand Qualifications Authority under the provisions of the Education and Training Act 2020 to provide education and training for school subjects and vocational courses.

All students study the New Zealand Curriculum in the Junior School and will be offered a range of subjects, and greater specialisation will take place in the Senior School where a very wide range of courses is offered.

The school is unstreamed throughout. This system has proven its worth. Students will be encouraged to take courses which suit their abilities and with individual course counselling we aim to develop an educational pathway for each student.

A Learning Enrichment Network exists to identify and support students with significant learning needs. Students may receive assistance from a Learning Enrichment Teacher or Teacher Aide in the classroom or in a special programme. Parents will be involved in developing individual educational programmes for students with special educational needs.

Students who will benefit from enrichment and extension are also identified and a range of opportunities are provided for them.

We offer a very large number of courses as listed in the Junior and Senior Curriculum Guides. The viability of some courses will depend on the number of students wishing to study the course.



The Junior School

Each child will be placed in a Form Class. These classes are given the code name of their Form teacher.

In Years Seven and Eight the class will do all of their subjects together. In addition to the compulsory core of subjects the students will study Technology, Music and Art. We aim to provide all students with skills to enable them to cope effectively with information technology.

In Years Nine and Ten students will continue to study the core subjects of English, Mathematics, Science, Social Studies, Health and Physical Education. In addition, they will be able to select three options in Year Nine and two options in Year Ten.

The option subjects are Art, Business and Economics (Year 10) Design and Visual Communication, Digital Technologies, Drama, Enterprise and Business, (Year 9) Food Studies, History, Music, Spanish, Te Reo Māori Studies, and Technology. The Junior Curriculum Guide describes these subjects in more detail.

http://www.kerikerihigh.ac.nz/info/kkhs_curric_guide_2024_jun.pdf

The Senior School

Kerikeri High School offers a full range of courses as detailed in the Senior Curriculum Guide.

These senior courses include:

Agricultural and Horticultural Science, Automotive, Biology, Business Management, Calculus, Chemistry, Design and Visual Communication, Digital Technologies, Drama, Economics, English, Entertainment and Event Technology, Geography, History, Hospitality, Human Development, Mathematics, Music, Outdoor and Environmental Education, Physical Education, Physics, Pathway Studies, Sciences, Spanish, Statistics, Te Reo Māori, Te Ao Haka, Technology (Engineering Design Systems and Control), Tourism, Visual Arts (Design, Painting, Photography).

The courses offered in the Senior School are fully described in the Senior Curriculum Guide.

www.kerikerihigh.ac.nz/info/kkhs_curric_guide_2024_sen.pdf

We have a strong academic record, and we are very proud of the academic achievements of our students.



As at junior levels, we aim to provide the education appropriate to your child's needs and abilities. Students may study courses at more than one level, provided they meet the pre-requisites for each course. We offer a full range of NCEA and Scholarship subjects. Other qualifications are also available in some subjects.

We strongly believe that Kerikeri High School should provide a balanced education for students, and a range of life skills and recreational courses are offered at senior levels. Students are placed in Form Classes in the Senior School according to Year Level.

Academic Opportunities

The school has outstanding facilities and we acknowledge the support of the Kerikeri community in providing such a fine learning environment. We look forward to showing you around the school on our Parent and Whānau Evenings.

The academic opportunities for students at Kerikeri High School include achievement in the National Certificate in Educational Achievement (NCEA) and in addition, competitions such as the Top Energy Science and Technology Fair, Australasian and other Academic competitions, Mathex, and Future and Community Problem Solving competitions. The school offers enrichment opportunities to identified students.

Academic achievement is recognised at Kerikeri High School at Celebration Assemblies and Prizegivings.

The elite academic awards of Dux and Proxime Accessit are presented to a Year Thirteen "Top Scholar" who, in addition to achieving at the highest level academically, are also achieving at an outstanding level in other areas across the Four Cornerstones.



Sporting

Sporting Opportunities

In order to build student confidence and self esteem, to teach respect for others and to develop skills and abilities, Kerikeri High School places great emphasis on its wide range of sporting opportunities. This is reflected in the enthusiastic participation of students across a very wide range of activities.

The sports that are offered at Kerikeri High School include Adventure Racing, Athletics, Badminton, Basketball, Chess, Cricket, Cross Country, Croquet, Equestrian ODE, Dressage and Show Jumping, Football, Futsal, Golf, Gymnastics, Hockey, Mountain Biking, Netball, Rugby, Rugby Touch, Rugby Sevens, Sailing, Softball, Squash, Surfing, Swimming, Tennis, Table Tennis, Volleyball and Waka Ama. We want all of our students involved in the wider life of the school.

We endorse Sport New Zealand's initiative on Fair Play which recognises the school's commitment to ensuring that Kerikeri High School students participate in a sport with integrity, sportsmanship and honesty. Balance is better.

The school has a recognised Smokefree and Vapefree status both in the sporting sense and within the entire school campus.

Through the assistance of Sport New Zealand funding, the school has the services of a Sports Co-ordinator and Sports Administrator. This ensures that the quality of the Sports programme offered is continually high and available to all students.

Sports equipment is available for students to use at lunchtimes. Physical Education staff open the Physical Education store each lunchtime to offer a variety of equipment for students to use at that time.



Cultural

Cultural Opportunities

Students are able to take part in Drama, Public Speaking, Auctioneering and Debating. Our music groups include our Stage Band and Rock groups.

Instrumental tuition is available to students in a variety of instruments. There is a charge to cover materials.

The Kapa Haka group practices and performs regularly, representing the school with mana, dignity, and strength. Year 7-8, and Year 9-10 Junior Kapa Haka groups also provide the Kapa Haka experience to a wide range of junior students.

Te Roopū Tautoko is a school led group that meets regularly to plan and provide kaupapa Māori opportunities for our students and staff.

Te Kotahitanga

After being a lead school in Te Kotahitanga (up until 2004), Kerikeri High School has maintained a teaching and learning Kaupapa based on our pou.

Mahitahi - Commitment to collective action.

Ako - Collaborative and responsive learning.

Manaaki - Mana, caring and connectedness.

Arts

The Kerikeri community has a strong interest in the Arts. This is reflected in our school which has a strong reputation locally and nationally in the Visual Arts.

The Performing Arts based in our modern Performing Arts complex adjacent to the Auditorium provides the opportunity for students to participate in curricula and extra curricula drama and music. Kerikeri High School has a strong reputation in the Performing Arts and is one of the few schools to offer Entertainment and Event Technology. Students have the opportunity to participate in major drama and musical performances.



Leadership

Student Leadership Opportunities

Students at Kerikeri High School are given, and capably assume, leadership responsibilities in many ways.

All Year Thirteen students are eligible to apply to be a Kerikeri High School Prefect. The successful Prefects are given leadership training and make a strong and positive contribution to the running of the school. A Head Boy, Head Girl and Deputies are also selected. Prefects work with Class Representatives and the Dean of each level, take a leadership role with the elected Student Council, and initiate and support activities for the benefit of all students. Prefects are positive role models and foster pride in our school.

The Student Council, chaired by the Head Girl and Head Boy, meets regularly so that students can have an input into the running of the school. A Class Representative is selected for each Form Class and through their Year Level Prefects or directly, they are represented at the Executive Student Council table.

Peer Support is a programme within the senior curriculum where senior students are trained to lead small groups of junior students in weekly activities throughout the first term. These links are very important between our senior and junior students, and we appreciate the contribution our senior students make to Junior School camps and tutorial activities.

Te Roopū Tautoko, the KERI Reading Programme, and coaching sports and teams such as Debating provide other opportunities for our senior students to develop their leadership potential and for their skills and abilities to be used for the benefit of others.



Education Outside the Classroom

Kerikeri High School offers an extensive education outside the classroom programme. In Term One, Year Seven students, with their Year Thirteen Peer Support Leaders, enjoy a Peer Support Camp.

Year Eight students participate in our one-day Wānanga at Whitiara Marae learning about reo me ngā tikanga and Ngāti Rēhiatanga.

The Year Thirteen students participate in a Leadership Training Camp.

Field Trips are subject based. Field studies are an essential part of many subjects including History, Geography, Science, and Social Studies. In English, Music, and Performing Arts trips are made to see films, plays and stage shows. Visiting groups often perform for students at school.

In addition, students are also offered many opportunities to visit tertiary institutions.

Other opportunities include those provided through week-long courses at the Hillary Outdoors Centre in Turangi.

International

We are pleased to host in our award winning International Department, fee-paying overseas students who come for a unique cultural experience of living and studying in New Zealand as well as participating in our leading Sailing Academy and Academic Plus programmes. Students come from Europe, Asia, North and South America. We welcome exchange students from many parts of the globe.

New Zealand students have the opportunity of being Kiwi Buddies to the new International Students to help them integrate into school and Kerikeri life. Lifetime friendships often start with the contact between our overseas students, New Zealand students and homestay families.

International students are happy to share their culture with your family. Lifelong friendships are made with students and their families from over the world. If you are interested in becoming a host family and join our fun and caring host family community, please contact our International Department on 09 407 0163 or email accomodation@kerikerihigh.ac.nz.



Excellence and Innovation

Specialist Facilities

Kerikeri High School has modern learning environments with welcoming classrooms, Auditorium, a large vibrant Library, Gymnasium, and the use of a swimming complex which includes a diving pool. We have a huge range of specialist facilities, a modern Performing Arts Complex, including Music facilities and a high tech Technology and Arts Complex. Other facilities include a Learning Enrichment Centre to cater for individual student needs, our Whare Hui, Te Pou O Manakō, and extensive playing fields and gardens.

Kerikeri High School has extensive computer access for students including specialist information technology classrooms and learning commons, as well as a state-of-the-art School-wide Wi-Fi Network. We also have an increasing number of portable sets of Computers On Wheels, or COWS, which are Chromebooks. Teachers can access these for class use.

We have state-of-the-art facilities: in 2009 we opened the Business Enterprise and Social Science Centre, in 2011 we created the Science, Mathematics and Information Technology Centre and in 2012 we launched the Culinary and Hospitality Centre.

Sailing

Kerikeri High School and the Kerikeri Cruising Club have produced winning sailors in national, inter dominion and world regattas.

Sixteen times since 1993 Kerikeri High School has won the New Zealand Secondary Schools' Teams Racing Yachting Championships going on to contest the Inter Dominion Teams' Racing Yachting Championship against the top Australian secondary school.

Kerikeri High School students and past students have won World Teams' Racing Titles, and many Kerikeri High School sailors have competed successfully at world level, including at the Olympics and Americas Cup campaigns.



High Standards

Our Expectations

Students at Kerikeri High School are given, and capably assume, leadership responsibilities in many ways.

Our happy and successful school observes high standards of behaviour. We strive to base all behaviours on our WAKA values.

W e are Learners	Whāia te mātauranga
A ct with Respect	Manaaki te tangata
K eep Yourself Safe	Tiaki tangata
A lways proud	Kia manawanui

We aim to develop self-respect, a pride in the school and a pride in appearance. We actively seek to promote a 'culture of care' for all in our school.

Theft, bullying, intimidation and violence will not be tolerated. The school will apply discipline to students involved with alcohol, drugs, smoking and vaping at school. Stand Down, Suspension or Exclusion may well result.

Respect for Environment

We encourage all students to protect the school environment. Students are encouraged to report any damage seen, to keep the school environment clean by not dropping litter and to assist us by picking up litter. We have very little vandalism but if students cause damage to school property, they may be required to pay for it. Students can join our SAVE group (Saving All Valuable Environments), helping both the school and community.

Smokefree and Vapefree

Kerikeri High School is proud to be Smokefree and Vapefree. Smoking and vaping is forbidden at school and when a student is in school uniform. Our policy includes all students, staff members and visitors to the school. We are setting a good example for the young people. Please help us to enforce this policy.



School Policies

All Kerikeri High School policies are available for reading through our School website. This is managed by School Docs via the following login details:

Username: kerikerihigh

Password: waka

Confidentiality

We have a Confidentiality Policy that applies the principles of the Privacy Act to Kerikeri High School. Information is disclosed as required, to appropriate Government agencies, for example, to enable our students to be enrolled for examinations with the New Zealand Qualifications Authority.

We require information from parents and contributing schools to assist with our enrolment process.

Please contact the school if you do not wish us to disclose any information to external health providers, eg dental services.

Stationery

Stationery lists are available from Kerikeri High School Reception and are also available on the school website www.kerikerihigh.ac.nz. Stationery items can be ordered from a range of online and local suppliers.

BACK TO SCHOOL

Your class stationery lists are available on our website www.nzschoolshop.co.nz and in store

We are local, NZ owned and operated
Supporting New Zealand Schools, it's just what we do

Local Stock Local People Great Prices Free Delivery Options

We are Community Minded
Proudly Supporting
Lifeline KidsCan hospice

Payment Options Available
Bank or credit card via PC&L
Online banking via PC&L
Pay in instalments via Afterpay
W&M (great card accepted in store)

21-23 Commerce Street Whangarei
info@nzschoolshop.co.nz
09 438 4879

Beat the rush and order back to school stationery now!

Class lists are ready to shop at

myschool.co.nz



School Uniform

Uniform for Years Seven to Twelve

Kerikeri High School is a school where school uniform is expected to be worn neatly and completely at school, travelling to and from school, and at school functions.

If there is a good reason why some item of uniform cannot be worn, a note must be brought from home to Te Puna Waioira prior to 8.40am and a short term exemption may be issued or the problem may be followed up in some other way.

Jewellery is discouraged for safety reasons and because expensive items can get broken or go missing. If you are concerned about jewellery, hair colour and/or make up, please talk with the year level Dean.

Kerikeri High School Uniform can be purchased through our uniform supplier, SAS, Uniform Shoppe, either online or at their retail shop located at State Highway 10, Waipapa. Their opening hours are currently:

- Tuesday 12-4pm,
- Thursday 2-6pm
- Saturday 12-4pm

Extended hours during the busy back to school season will be advertised.

Online ordering is available at www.theuniformshoppe.co.nz/location/kerikeri, please be aware that delivery is usually 3-4 days at peak times.

Some second-hand uniform will be available for purchase via our Reception.

Year Thirteen Dress Code

The Year Thirteen students also have a dress code. They may wear tidy day wear, provided that they present themselves well. As for other students at school we expect Year Thirteen students to be neat, clean and to take pride in their appearance. Jandals, scuffs, work boots and socks, beach wear, collarless T-shirts, non-School beanies and skimpy clothing e.g, showing bare midriiffs, and clothing with large advertising logos are not permitted.



Regulation Uniform

Jersey:	Regulation navy.
Shirts:	Regulation short sleeved polo shirt – white or jade.
Jacket:	Regulation school jacket. This jacket may be worn in classes, other than workshops or laboratories.
Navy Skirt:	Regulation school skirt. Specified length just above the knee.
Navy Dress Trousers:	Regulation trousers must be properly hemmed and may not be worn rolled up.
Navy Shorts:	Regulation navy shorts.
Physical Education:	Regulation shorts and t-shirt. This uniform will also be used while representing the school in certain sporting events.
Shoes:	Any flat, low soled plain black leather or black canvas laceup shoes. As an alternative, girls can wear a flat black leather shoe with an instep strap or a flat shoe with a high instep, eg “Mary Janes” T bars are allowed.
Sandals:	Any black, flat-soled sandal with a back support (no jandals, scuffs or crocs). No socks to be worn with sandals. Black “Birkenstock” style sandals may be worn.
Socks:	Plain white, navy or black socks may be worn. In winter approved navy tights may be worn if preferred with the skirt. Socks and tights may not be worn together.
Scarf:	Regulation school scarf, may be worn in classes, except laboratories and workshops.
Hats:	Regulation school beanie, bucket hat and cap may be worn outdoors. Any cap will be allowed.
Sunglasses:	Sunglasses may be worn outdoors.

If in doubt about any uniform item please ask an Assistant or Deputy Principal.

We encourage students to wear sunscreen, sunglasses and hats when outdoors especially during Term One and Term Four.



Kerikeri High School Representative Hoodie

Kerikeri High School Representative Hoodies are available for students who meet the school's approved criteria, as described below.

The intention of the hoodies is to provide students, who represent the school and meet the hoodie criteria, with a comfortable and appropriate casual garment that they can wear to mid-week and weekend school sports fixtures and qualifying Four Cornerstone events.

The school reserves the right to review and amend the criteria for Representative Hoodies as needed.

To qualify for a Representative Kerikeri High School Hoodie, the student will:

- be in a selected team which represents the school on a regular basis – this can include individual sports, e.g. Athletics, Tennis, etc... if the student represents the Kerikeri High School at Northland Secondary Schools Association or National events.
- or be involved in a Four Cornerstone activity representing the school on a regular basis, in a selected group or individual activity. This can include: Debating, Kapa Haka, Stage Band, Rock Quest, Student Librarian, Student Council, etc.
- participate in Peer Support training and represent the school while attending the Year 7 camp at Urupukapuka Island.

All Representative Hoodies must have at least one qualifying Four Cornerstone activity listed under the school logo. Subsequent qualifying activities may be added to the Representative Hoodie over time, with a formal letter from the school approving the addition(s). New Representative Hoodies may have qualifying Four Cornerstone activities added retrospectively with formal written approval from the school.

The Representative Hoodies will have the student's initials embroidered on to the lower back right of the hoodie. Please contact the school to receive the correct documentation to allow the purchase of the Representative Hoodie from the Uniform Shoppe. Representative Hoodies will not be distributed to students without the relevant details included on them.

Hoodies are purchased on the understanding they are unique to the purchasing student and are not transferable to siblings, friends etc.





Student Bus Transport

The main school bus service in the Kerikeri schools' area is provided by the Ministry of Education (MOE), to assist eligible students to travel from their home to school. For some years funding provided has been managed by the Kerikeri Schools' Transport Network (KSTN), who contract Clarks Coachlines to provide the service. Clarks Coachlines provide us with an extremely efficient service, with a modern, well-maintained and impeccably presented fleet of buses.

The Ministry of Education completed a full route review in August 2023. As a result, there will be significant changes to the network later in 2023. These have not been finalised at the time of printing. School will keep parents notified of alterations as they occur.

Eligibility for School Transport Assistance

Each school has a Transport Entitlement Zone (TEZ) surrounding it, with the outer boundary being the mid-point between it and the next similar school.

Students may be eligible for a place on a KSTN bus in one of two ways:

1. If they attend the closest school available and reside at least 3.2km for Year Seven and Eight or 4.8km for Year Nine to Thirteen from that school, they are "Eligible" students.
2. If they attend a school that is not the closest available to them and reside more than 3.2km/4.8km from their closest school, they are designated "Transfer of Eligibility" students.

Students not meeting either of these criteria are "Non-eligible" students. All students will receive a Student ID Card annually. These will be used by Bus Drivers to identify students eligible to take the bus. We recommend students take a photo of this ID Card once received. Students who lose their card will be charged \$1 for a replacement.

Using the bus

"Eligible" students have a place on the school bus on a route determined by KSTN.

"Transfer of Eligibility" students have a place on the school bus from a scheduled stop within the school's TEZ on the shortest route to the school. That stop must be more than 3.2km/4.8km from the school. Families must arrange to transport the student to/from that stop.

Non-Eligible students have no right to a place on any KSTN school bus. However, under certain conditions it may be possible to use a network bus by paying a fare.



Passenger Fares

Where space is available, the KSTN allows non-eligible student passengers who must pay a fare. Schools have details of the fares which are set by the contractor. This service is very limited and not guaranteed, as the eligible user numbers vary day-by-day, and will not be available if there are any standing passengers. Unfortunately, because of loadings, no space is available on any bus serving Waipapa so students are not able to use the buses to travel to sports practices at Waipapa.

Students Conveyance Allowance

In many cases, buses do not travel to the TEZ boundary. This may be because there is no suitable terminus, or there are few eligible students, or the road is unsuitable. Students are expected to make their own way for up to 2.4km to the terminus bus stop. Where the distance is greater than 2.4km parents may apply for a conveyance allowance to assist with costs. The application form is available at parents.education.govt.nz/primary-school/your-child-at-school/school-transport-assistance/#apply

Caregivers should apply for the allowance in Term 1 to ensure the full annual allowance is received. The allowance is paid in retrospect at the end of each term. Once approved, the allowance remains active until the student leaves school or changes their address. A new application must be made as soon as a student changes address.

Bus Loading

Our aim is to have all students seated. Some routes do require some students to stand. However, no bus has been overloaded, and all drivers have strict instructions to not ever exceed the legal loadings. Most buses are licenced to carry around 20 standing student passengers.

We expect a high standard of behaviour from our students who are travelling on buses. Sensible behaviour is absolutely essential to the safety of students who travel by bus.

Bus Bay

Loading the large number of students efficiently and safely onto buses at the end of the day is a challenge. The twenty buses will not all fit in the bus bay, so they arrive at set staggered times. If even a single car is parked in the bus bay the process is considerably slower, leaving buses on Hone Heke Road unable to enter the bay and blocking all road traffic. Please do not park in the bus bay between the times displayed on the signs.

Queries

All queries regarding the bus services need to be made to the school. The contractors are not able to make decisions about routes, or casual passengers.

Private Buses

In addition to the KSTN bus service, there are Clarks Coachline buses serving the Paihia, Opua, Kaikohe and Matauri Bay areas, and Stewarts serving Kaeo. All these are fare-paying services.



Transport Entitlement Zone Boundaries

Year 7 and 8 Eligible Addresses (numbers included)

Students must reside more than **3.2km** from the school by the shortest route. These internal boundaries are;

Inlet Rd greater than >223

Blacks Rd >20

Kotare Heights >20

Kerikeri Rd >483

Access Rd >43

Maraenui Dr >25

Waipapa Rd >140 and 30-45

Silkwood Ln >40

Blue Marlin Dr >40

James Kemp Place 1, 5, and >10

Mission Rd, 23A, odd 25-37, >38

Landing Rd odd >53, even >100

Kendall Rd 1A and >3

Year 9 to13 Eligible Addresses (numbers included)

Students must reside more than **4.8km** from the school by the shortest route. These internal boundaries are;

Inlet Rd greater than >390

Rarere Tce >60

SH10 <1380 and >1500

Wiroa Rd >50

Waipapa Rd >308

Karaka Dr >8

Waitotara Dr >45

Puriri Park Lane >30

Kapiro Rd/Landing Rd corner

Newton Watts Dr >14

Students must also reside within the KKHS TEZ boundary, which is defined by the mid-point between KKHS and the next school they could enrol at. These boundaries are;

SH10 between 1165 and 2930 (Oromahoe, Whangaroa)

Waimate North Rd <895 (Oromahoe)

Wiroa Rd <754 (Okaihau)

Lodore Rd <290 (Okaihau)

Puketotara Rd <934 (Okaihau)

Mangakaretu Rd <620 (Okaihau)

Pungaere Rd <1212 (Whangaroa)

Also Purerua Rd <20

Stanners Rd <360 but by agreement with BOIIA the KSTN transports students residing in the Purerua area outside these two boundaries.

SH10 between 201(BOIC) and 2930 (Whangaroa)

Oromahoe Rd >1311 (BOIC)

Puketona Rd <363 (BOIC)

Old Bay Rd >222 (Okaihau)

Te Ahu Rd >641 (Okaihau)

Waimate North Rd <1070 (Okaihau)

Wiroa Rd <754 (Okaihau)

Lodore Rd <290 (Okaihau)

Puketotara Rd <934 (Okaihau)

Mangakaretu Rd <620 (Okaihau)

Pungaere Rd <1212 (Okaihau)

The operation of the wider KSTN Transport Zone may include students outside these eligibility boundaries. However, students within these boundaries are the only ones with full eligibility to transport.

School Addresses

- Pakaraka Primary School; 6810 SH 1, 1 SH 10
- Oromahoe School; 48 Oromahoe School Rd
- Whangaroa College; 4134 SH 10.
- Okaihau College, 58 Settlers Way



Morning Bus Routes – Scheduled Times

Please note: Accurate as at 4 September 2023

KK1 Pungaere 7.50am Pungaere/Waiare Rd Intersection 8.05am Onekura Road End of seal Turnaround 8.20am Waipapa Road Rainbow Falls Road	KK8 Opito Bay 7.45am Opito Bay by Park Bench 8.00am 197 Rangitane Rd Redcliffs Rd TeKowhai Rd Corner Bus Shelter 8.12am 8.20am Skudders Beach Corner
KK2 Takou Bay 7.40am Te Ra Road Settlement 7.45am 366 Otaha Road 7.55am 394 Takou Bay Road Bus Turns 8.05am SH 10 Rest Stop 8.18am Kapiro Service Station	KK9 Puketotara 7.40am Puketotara Road 7.50am Mangakaretu Road 8.00am Tyree Road 8.15am Mawson Avenue
KK3 Inlet Road 7.39am Wharau Road 7.55am Edmonds Road 8.05am Reinga Road	KK10 Waipapa West 7.40am Cnr SH10 & Waipapa West Roads 7.45am Ness Road (turnaround) 7.50am Cnr Kapiro & Conifer Lanes
KK4 Te Tii 7.55am Te Tii Village 8.10am Keridowns Rd 8.14am River Drive	KK11 Oromahoe 7.30am 500 SH10 7.40am Wakelin Road 7.56am Oromahoe Rd transfer
KK5 Stanners Road 7.53am 47 Sandys Rd 8.00am 40 Stanners Rd 8.08am 354 Stanners Rd (Landcorp) 8.15am Sommerville/Purerua Rd Intersection 8.22am Palm Drive	KK12 Triangle 7.58am Ngapuhi Road 8.05am Riverstream Drive 8.12am SH10 Truckstop 8.19am Redwoods
KK6 Puketona (Connects to KK11) 7.20am 1188 State Highway 10 7.26am Puketutu Drive 7.28am Lily Pond Lane 7.35am Halyard Loop 7.43am Retreat Road 7.56am Oromahoe Road transfer 8.15am KKHS	KK14 Airport 7.40am 23 Wiroa Road 7.42am 111 Wiroa Road 7.44am 301 Wiroa Road 7.47am Lodore/Ricker Road Intersection 7.51am Lodore/Wiroa Road Intersection 7.53am 466 Wiroa Road 8.00am 20 Waimate North Road 8.10am Waipapa Road 8.25am Inlet Road to Reinga Road (Primary only) 8.30am Darwin Road (Primary only) 8.40am Reinga Road – Fuller Tce (Primary only)
KK7 Waimate 7.40am Crossroads - Wiroa, Waimate North Rd 7.53am Te Ahu, Waimate North Rd 8.05am Old Bay Road x Te Ahu 8.15am SH10 Orange Centre	
KK3a Airport (Primary School only) 8.13am Depart KK School 8.20am SH10 - Poplar Lane 8.30am Springbank School 8.45am Kerikeri Road	KK10a Waipapa West (Primary School only) 8.10am Waipapa Road opposite Mawson Avenue 8.15am Cnr SH10 & Waipapa West Roads 8.20am Cnr SH10 & Waipapa West Roads 8.32am Riverview School 8.42am Kerikeri Primary School



Community

Parents and School

Parents and caregivers are always welcome at Kerikeri High School. If you are coming to school please call at Reception for assistance. Reception is open from 7.45am - 4.00pm during the term and the School Newsletters will advise you of the opening hours during the school holidays.

Parents and caregivers are required to enrol their children personally and we require you to make an appointment to do this before the starting date for the student. This enables us to ensure that the Dean is available and makes your child's transition to a new school go much more smoothly.

We encourage parent involvement. Parents can be involved in many ways:

- Going with the class on field trips
- Coming to school sporting events
- Coming to our Drama and Musical Evenings
- Offering to Coach or Manage a sports team
- Offering to assist, for example, in the Library
- Offering to be a Reader/Writer
- Offering to assist with the Kapa Haka or other cultural groups
- Attending Board and Parent Teacher Association meetings
- Attending our Open Evenings, Year Level Evenings and Report Evenings.

School Communication

Please do not hesitate to contact the school if you have any questions or concerns. Reception or your child's Form Teacher will be able to help you find the person best suited to assist you.

Communications may be sent from the email noreply@kerikerihigh.ac.nz so please make sure this a trusted email or check your junk folder.



Newsletters

We email Newsletters home on a regular basis and for those without an email address, a copy is posted to you. These are dated and are also available on the School's website www.kerikerihigh.ac.nz. If your Newsletter arrives in the post this means we do not have your email address. Please phone Reception on 407 8916 or send an email to enquiries@kerikerihigh.ac.nz so we can get you on the list for faster communication.

Daily Notices are also available on our website.

The Kerikeri High School 'App'

Download the App from the Apple Store or Google Play Store for free to:

- Send student absentee notifications
- Check the Daily Notices
- Keep up to date with School News and events
- Receive notifications that are useful to you and your student via alert subscriptions
- Check Revision Classes
- Plus handy links for students to access their School Office 365 account and curriculum resources and more
- Search for SchoolAppsNZ in the app store to install



Student Accounts

On enrolment, a Family School Account will be created, which will include a Family Key. Please use this Family Key as a reference for any payment you make online to ensure this is assigned to the correct family. Our School bank account for payment is 12-3091-0120756-00.

Statement of Contributions will be sent on a regular basis. On these statements will be a link to access your payment portal. This will allow you to check your account at any stage and pay any charges online quickly and easily.

If your child participates in optional events or trips during the year, further information including a permission slip will be provided and the cost will be added to your account. It is the expectation of the School that any optional trips and events are paid prior to the event happening. Where this proves difficult to pay, we welcome automatic payments to spread the cost over the year. This can be arranged through your bank.

The School has processes in place to ensure all students can access the curriculum and if Parents and Caregivers are encountering financial difficulties please contact your child's Deputy Principal.



Information Technology

At Kerikeri High School we recognise the value of information technology in enhancing teaching and learning. Kerikeri High School operates a state-of-the-art School-wide Wi-Fi Network, with a secure, filtered ultra-fast broadband connection. There is a well developed computer network with filtered internet access that plays an integral part in curriculum delivery.

Microsoft 365

All students at Kerikeri High School are provisioned with a school network and Microsoft 365 Account. This provides students with a Kerikeri High School email address, access to Microsoft Office Online, including cloud storage and access to apps such as Word, PowerPoint and Excel online, as well as the ability to install Microsoft Office on up to 5 personal devices, including Windows PCs, Macbooks, iPads and Android devices for free. More information is available on our website.

Bring Your Own Device

Bring Your Own Device (BYOD) is not compulsory; however students are encouraged to bring their own device to School to support their learning as appropriate. We believe that devices can be a powerful tool in teaching and learning, however are only one of a range of tools that may be used in the classroom. Students are able to access the curriculum whether they have their own device or not.

We recognise that students and their families may already own, or want to have a choice in the type of device that is brought to school, and so the School will not be stipulating that students are required to have a particular device as some schools have. This will allow for a range of devices and prices.

In addition to computer labs throughout the School, we provide as many Chromebooks for student use as shared devices as possible, however students having a personal device to use has many advantages for continuity of work, personal storage as well as personal preference for device type.

BOYD Devices should meet the following minimum specifications:

- Battery A minimum of 4 hours of battery life
- Browser Devices must have a modern internet browser such as Chrome, Edge, Safari or Firefox
- Screen Size 11 inches minimum for Laptops and Chromebooks
- Input Device Permanent or removable external keyboard



The School recommends that Students use either a Windows or MacOS/iOS based device. Chromebooks may also be used. As an Office 365 School, Windows or IOS is our preferred operating system. Minimum versions should be:

- Windows 10 or above
- MacOS – v11 or above
- IOS – v15 or above
- Chrome OS – Upgradeable to the latest version

Please treat these recommendations as a minimum specification – some, particularly specialist senior subjects, may have recommendations for device specifications that exceed these if students are considering using their own devices. Examples may include Photography and Art Design.

Looking ahead, if your student is considering bringing a digital device to School, below are some points you should consider:

- It is our advice that devices brought to School should be stored and transported in a protective bag or sleeve to minimise potential damage.
- All devices are required to have a password, lock pattern or some other sort of security protection to prevent unauthorised access.
- Devices should be brought to School fully charged – there will not be charging facilities for students' devices.
- The security of devices brought to School will be the responsibility of the student. While reasonable efforts will be made by the School to ensure the safety and security of devices brought to School, no liability for the loss or damage of a device will be held by the School. Insurance of devices is the responsibility of families. Devices and their accessories should be clearly labelled, and serial numbers recorded in a safe place in case of loss.
- All internet use is filtered and monitored by our state-of-the-art internet Firewall to ensure that students are not able to access inappropriate content on their devices via the School Network. Students are required to install a Network for Learning Security Certificate on their device to be able to access our Wi-Fi network,

As technology moves and develops, so will these device specifications and recommendations. We look forward to working with our School community to make this successful and accessible for all students and their families.

IT Ninjas

Knowledgeable senior students, known as IT Ninjas are available to assist students with any technology queries. Availability will be advertised in the Daily Notices at the start of the year.



Cybersafety Acceptable Use

All students sign the Cybersafety Acceptable Declarations when they enrol. A culture of safe and appropriate use of technology is promoted. As responsible users of Information and Communication Technologies (ICT), students are expected to keep themselves and others cybersafe as follows:

Students can only use the School's ICT equipment for schoolwork and must not:

- Access, or attempt to access, inappropriate, age restricted, or objectionable material.
- Download, save or distribute such material by copying, storing, printing or showing it to other people.
- Make any attempt to get around or bypass security, monitoring and filtering that is in place at school. This includes the use of VPNs. If students accidentally access inappropriate material, they should not show others, immediately turn off the screen or close the window and report the incident to a Teacher straight away.

Username and Passwords

- Students will be issued with a unique network username and given the opportunity to set their own password. They are required to keep their password secure and not share it with anyone else.
- Students must only log on to the network with their own Username and Password and must log off when finished.
- Students must not share their password with anyone and must not let anyone else use a computer that they have logged on to. Students will be held responsible for anything done using their Username and Password.

Private Equipment Is Included

- These policies also apply to any privately owned ICT equipment or devices such as mobile phones, USB flash drives, digital cameras or personal music players that students bring to school or to a school-related activity.
- Any images or material on such equipment or devices must be appropriate to the school environment.

No Bullying, Harassment or Breaches of Privacy

- Students will avoid any involvement with any material or activities that could put at risk the safety, security or privacy of any member of the school community. This applies both at school and off campus.
- Students must not at any time use ICT to upset, offend, harass, threaten or in any way harm anyone connected to the School or the School itself.
- Students must not give out any personal information about any other person without that person's permission. Personal information includes names, addresses, email addresses, phone numbers, and photos.



Take Care of the School's Equipment

Students must treat all ICT equipment and devices with care and respect. This includes:

- Not intentionally disrupting the smooth running of any of the School's ICT systems.
- Not attempting to hack or gain unauthorised access to any system.
- Following the School's cybersafety policies and procedures, and not joining in if other students choose to be irresponsible with ICT.
- Reporting any breakages or damage to a staff member immediately.

The School monitors traffic and material sent, received or stored using the School's computer network. The School uses filtering systems to restrict access to Internet content and services.

The School audits its computer network, internet access facilities, computers and other School ICT equipment/devices and may commission an independent forensic audit if required. Auditing of the above items may include any stored content, and all aspects of their use, including email.

Routines

The School Day

- | | |
|-------------------------------------|------------------------|
| • Start of Day Bell | 8.35am |
| • Form Time | 8.40 – 8.55am |
| • Period 1 | 9.00 – 9.55am |
| • Period 2 | 10.00 – 10.55am |
| • Interval | 10.55 – 11.15am |
| • Period 3 | 11.20 – 12.15pm |
| • Period 4 | 12.20 – 1.15pm |
| • Seated Lunch (Years 7 -10) | 1.15 – 1.30pm |
| • Lunch | 1.30 – 2.00pm |
| • Period 5 | 2.05 – 3.00pm |

Office Helper

For many years Kerikeri High School has operated a "Service to the School" system where students are given an opportunity to show responsibility by participating in school service activities. One of these activities is Office Helper. Year Seven students are introduced to this service in Term Three each year and will continue for Term Four and the first term of the following year. Each class is timetabled into the programme for a two-week period.



Homework

Students are expected to do homework during the school week and we recommend the homework set be recorded in students' electronic calendars/ diaries.

Homework includes:

- Completion of class work
- Preparation for new work
- Revising work already covered
- Research
- Extended projects
- Catching up on notes missed when students are absent

If formal homework is not set students are expected to organise their bookwork and revise.

The amount of homework completed varies according to the year level.

Parents can help by checking their student's electronic calendar at least once a week, helping students with time management and providing a quiet place, a chair and table, and a good light.

Library Books

Library books are issued free to students and we ask that they be well looked after. Students will be charged for lost or damaged books. The Library has a computerised catalogue and book issuing system.

School Canteen and Lunches

Our canteen provides a range of healthy food for our students and staff. We encourage students to order their lunch online via our website or www.lunchorders.co.nz.

Student Vehicle Transport

Students may bring vehicles to school but only under strict conditions. Sensible driver behaviour is insisted upon and student drivers must not take passengers other than those approved by the students' parents and the School. Students must stay within the parameters of their Restricted Licences at all times. In the interests of student safety, we will withdraw the permission for a student to bring a vehicle to school if these rules are ignored. Students can get a Vehicle Permission Form from Te Puna Waiora which clearly details all conditions and are requested not to bring a vehicle until permission is granted.

Students will be required to conform to school rules with regard to vehicle travel and parking.

Cycle Helmets

Cycle safety helmets are compulsory by law. We insist that students wear their cycle safety helmets cycling to and from school and encourage parents to enforce this safety measure. Bike racks are provided by the Library and are monitored by CCTV Cameras. Electric scooters are not permitted to be stored in school buildings.



Te Puna Waiora

Te Puna Waiora is our student centre which assists students. Te Puna Waiora staff are available to provide town leave passes (with a note from home), to assist with lost property, care of student property, urgent telephone calls, school information and the whole host of things that students might need to help their day at school go more smoothly. It is easy to contact each Year Level Dean as the Deans have offices in Te Puna Waiora. Te Puna Waiora also administers the attendance of students, including students who are late or out of class for some reason.

Attendance

Full attendance is very important. Students cannot achieve at school without good attendance and we encourage parents to think very carefully before scheduling family events during term time. Prior permission from the Principal is required for absence other than sickness and bereavement.

All absences should be accounted for and can be explained by parents and caregivers through the School App or by a note from the parent or caregiver to the Form Teacher when the student returns to school. If the student is likely to be absent longer than three days, we encourage parents to ring Reception or Te Puna Waiora and in cases of illness we can assist with work that can be done at home. A doctor's certificate should be obtained for absences of more than five days.

Students must sign out at Te Puna Waiora if they leave during the school day for an appointment. They must have a note or an appointment card. Similarly, they must sign in, with a note, if they arrive after 8.40am.

Emergency

A sick or injured student at school must report to the St John Centre, in Te Puna Waiora.

We have First Aid staff to assist students requiring attention. It is most important that parents and caregivers keep the school informed of any changes to address, email and contact details, so we can immediately contact you in case of an emergency.

Only when a parent or caregiver has been contacted will the student be released from the school to go home unwell. Unwell students must be collected by an adult and cannot be sent home unaccompanied.

Public Health Nurse

A Public Health Nurse is available onsite at various times to assist with a range of health needs, skin issues, injury, sexual health and contraception, etc.

Nurse visits are free and confidential. No pre appointments are required and the nurse can be contacted confidentially via text, as advertised regularly through our Daily Notices.



Students' Property

It is absolutely essential that all property brought to school is named, including all school uniform items. The School will not accept responsibility for items such as skateboards, cellphones or jewellery and students are strongly discouraged from bringing any valuable items to school.

We will make every effort to find lost articles that are named. Lost Property is handed in to Te Puna Waiora and students are contacted for the return of all named property.

At Kerikeri High School, the teachers can request the surrender of an item, and retain or dispose of the item. Teachers can request the surrender of items that they have reasonable grounds to believe will endanger safety, detrimentally affect the learning environment, or be harmful. In most cases, surrendered items are available for collection at the end of the day following a phone call from the Teacher.

Students' Personal Phones

Students' phones are not permitted to be used in class, unless specifically required by a teacher. All phones must be off or on flight mode and kept in students' bag during class time. Students are not permitted to leave classes with their phone.

Telephone

There is a telephone available for student use in Te Puna Waiora.

Town Leave

Town leave at lunchtime will be granted to Year Seven to Twelve students at the discretion of the School for reasonable reasons. Students are required to take a note describing the request, with reasons, from their parent or caregiver to Te Puna Waiora before school. Permission will not be given for the purchase or eating of food in town.

Wellbeing

From time to time everyone needs some information, advice or a listening ear. Our School provides a number of people you can talk to. The Form Teacher is often the teacher you know best and can either help sort out difficulties or put you in touch with someone else.

You may also wish to contact the Year Level Dean, one of our School Counsellors, or the Careers Adviser.

The Assistant Principal or Deputy Principal for your child's Year Level will also be more than willing to help you with any problems.



Student Enrolment

Enrolment Scheme

Kerikeri High School has an Enrolment Scheme that meets the legislative requirements to ensure that overcrowding, or the likelihood of overcrowding, is avoided at Kerikeri High School. The Enrolment Scheme protects automatic entry for those living within the Home Zone and enables some Out-of-Zone access.

Confirmation of Automatic Entry for in zone students is by completion of the formal application procedure.

Kerikeri High School Enrolment Zone, Description of Boundaries

All students who live within the Home Zone described below shall be entitled to enrol at the School.

Starting at the corner with Waiare Road, the zone travels east along Pungaere Road, and turns north into SH10. It continues travelling up the centre of the highway to the intersection with Takou Bay Road.

The zone travels down Takou Bay Road (properties on both sides of the road are in-zone) to the coast, and then travels south along the coast until it reaches Kaipatiki Rise (all properties to the west are in zone).

The zone then travels south across country and crosses Oromahoe Road at No.27. It continues west, including all of McDonald Road, Hupara Road from the end of McIntyre Road (McIntyre Road to No.810 included) and reaches the McIntyre Road/Whangae Road intersection (Whangae Road Numbers 300 – 770 included).

Continuing overland in a westerly direction it crosses SH10 at No.210, Old Bay Road at No.239, and then North to Te Ahu Ahu Road at No.673. It then travels across country to cross Waimate North Road at the southern boundary of No.655 Waimate North Road and continues north-west (No.660 Waimate North Road included) until it reaches the intersection of Wiroa Road and Lodore Roads.

It continues along Lodore Road (Lodore Road East included) until it reaches the intersection of Waiare Road (excluded). It then travels overland north until it reaches the intersection of Puketotara Road and Mangakaretu Road. It continues up Mangakaretu Road round and back to Puketotara Road. It travels north to meet Waiare Road at 1354 Waiare Road (excluded). It then travels north up Waiare Road (properties on the Eastern side only included) until it reaches the starting point at the Waiare Road intersection.



Enrolment Zone

INDICATIVE ONLY – PLEASE REFER TO THE DESCRIPTION OF BOUNDARIES FOR EXACT DETAILS

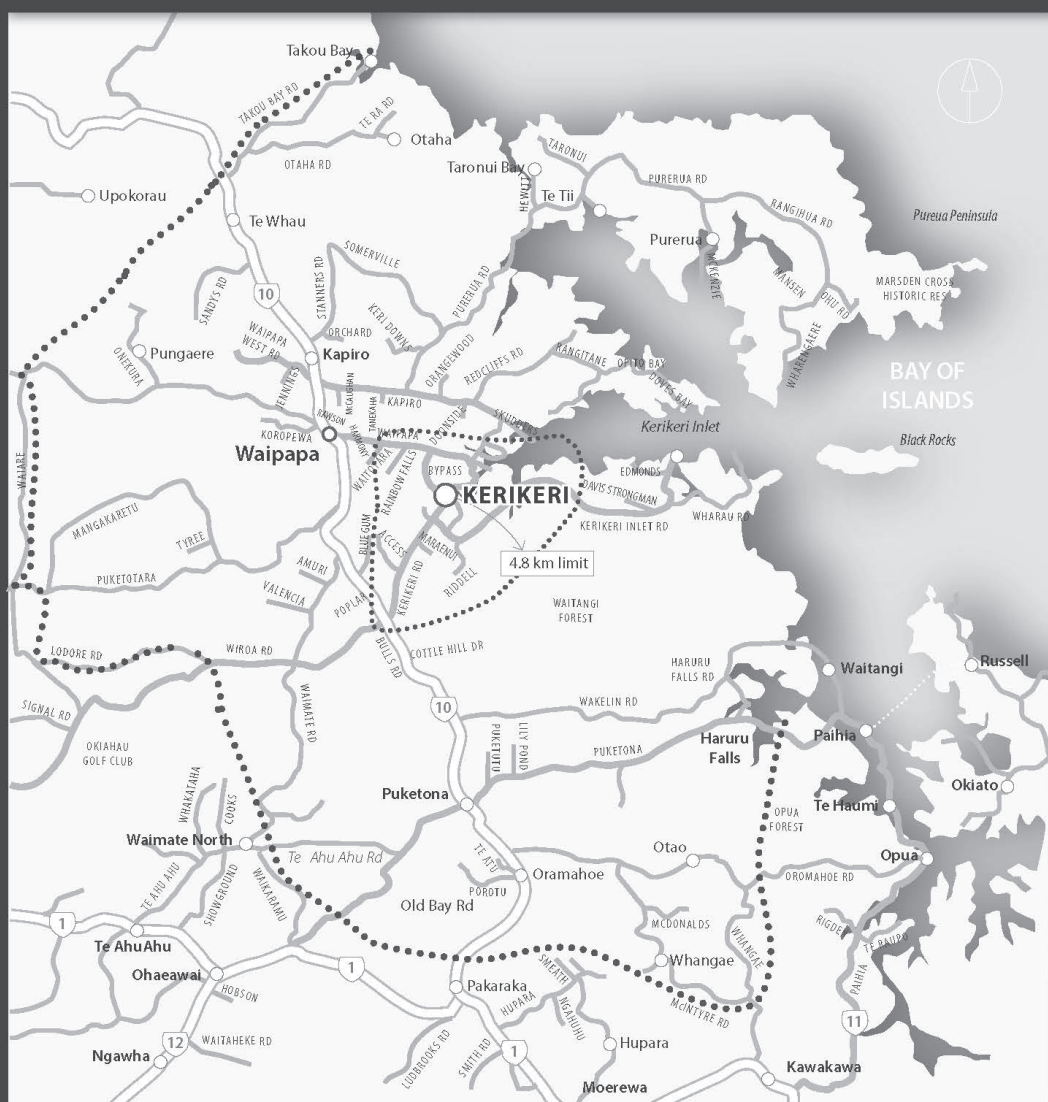

Inside the dotted line is the Kerikeri High School Enrolment Zone.

All bus students are expected to walk up to 2.4 km.





Kerikeri High School

Kerikeri, Bay of Islands
New Zealand

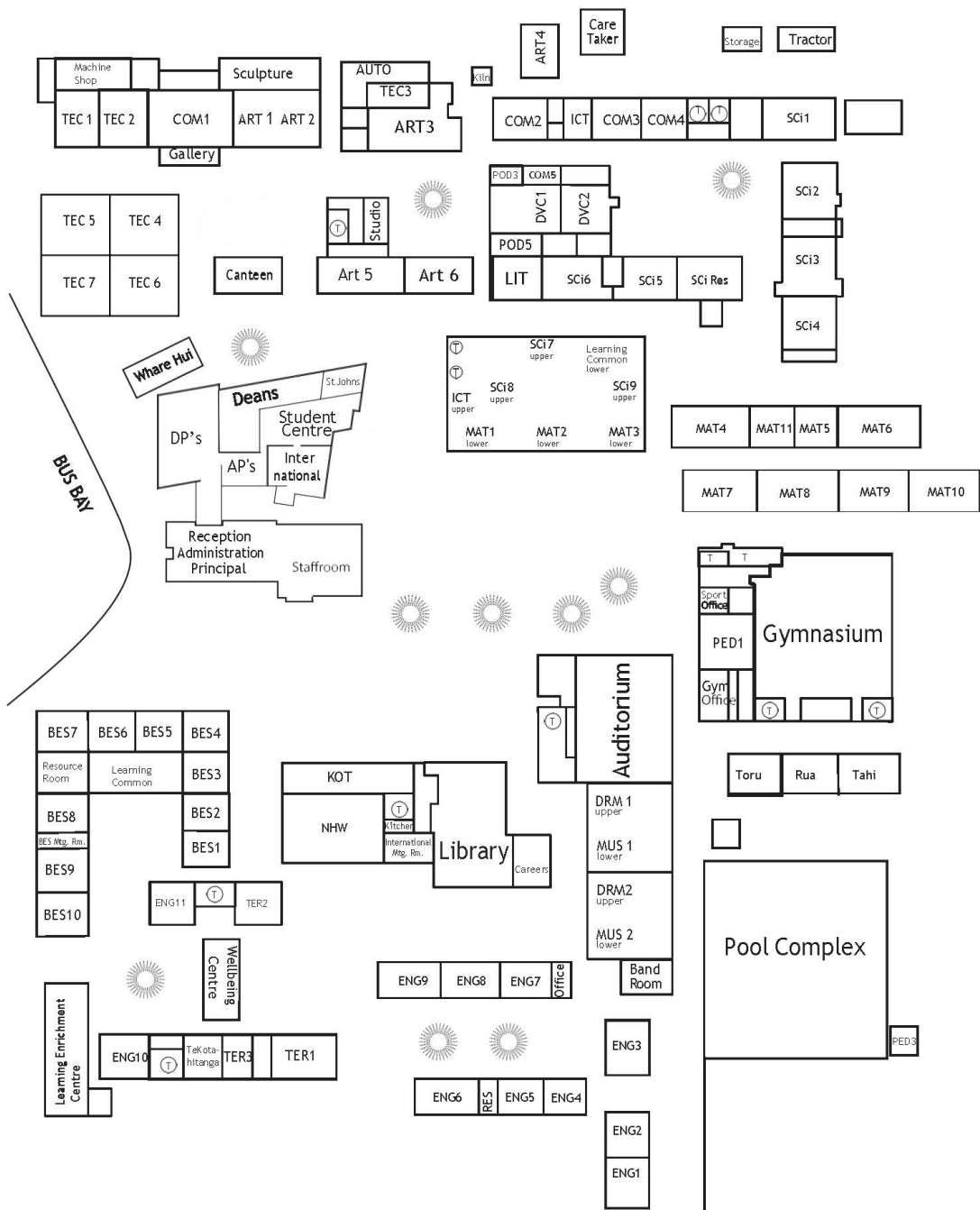



Important Dates and Enrolment Information for Parents

New Students & Whānau Evening – Thursday 21st September 2023 – 6.30pm

Kerikeri High School Library

Meet the Principal, the Deputy Principal, the Assistant Principal, the Dean of Year Seven and the 2023 Prefects to find out what is offered to students at Kerikeri High School.

Enrolment Evening – Thursday 12th October 2023 – anytime between 4.00pm – 7.00pm

Kerikeri High School Library – no appointment necessary

This is your opportunity to tell us about your child and to learn about some of the school structures. You will also be offered a tour of the school accompanied by a student.

The First Day

Parents must make appointments to enrol their children before their first day of school to enable their first day of attendance to proceed smoothly.

Students should bring writing materials and wear correct uniform. The Year Level Dean, staff and senior students will help guide new students.

Students will spend the first morning of the new school year with their Form Teacher but should be prepared to begin work immediately.

2024 Starting Dates

Confirmed starting dates will be available on our calendar via our School App and website at the start of the school year.

Your first day of School in 2024 is:

Year Seven	Friday 2 February. Staff and Peer Support Leaders will assist Year 7 students to find their Form Rooms where they will have their first Form Time at 8.40am. Parents and Caregivers are welcome to return for the Pōwhiri at 9.30am in the Gymnasium. Year 7 students, please bring your togs.
Year Eight	Monday 5 February, 8.40am
Year Nine	Wednesday 7 February, 8.40am
Year Ten	Wednesday 7 February, 8.40am
Year Eleven	Wednesday 7 February, 8.40am
Year Twelve	Monday 5 February, 8.40am
Year Thirteen	Friday 2 February, 8.40am (Includes course selection)



We welcome your interest in enrolling your child at Kerikeri High School.

In-Zone Applications

Your child has an absolute right to attend Kerikeri High School if you reside permanently in the Kerikeri High School home zone. To confirm automatic entry, you are required to complete an In-Zone Application with documentation to prove your residential address. Please note that “reside permanently” means that the student lives permanently with their parent/s or legal guardian/s within the Kerikeri High School home zone.

Please ensure the completed In-Zone application is returned to Kerikeri High School Reception as soon as possible to enable timetable planning to begin for 2024 and help determine the number of Out-of-Zone places we can offer.

Enrolments forms are available for completion on our website below or a manual form can be collected from Reception. Links and information will be automatically sent to parents of contributing Primary Schools.

<https://www.kerikerihigh.ac.nz/enrolment-procedure.php>

Out-Of-Zone Applications

If you live out of the Kerikeri High School home zone, as per the zone description of boundaries, you must complete an Out-of-Zone Application for commencement at the beginning of the next academic school year. Please contact Reception or check our website in August to view the dates these applications will be open for consideration.

The exact number of places available for Out-of-Zone students will depend on incoming student numbers who live within Kerikeri High School’s home zone, and overall student numbers in current year levels. If there are more applications received than places available at any Year Level the allocation of Out-of-Zone places will be by ballot within the priorities outlined below.

Applications from Out-of-Zone students will be processed in the following order of priority:

- First Priority will be given to students who have been accepted for enrolment in an approved special programme
- Second Priority will be given to applicants who are siblings of current students
- Third Priority will be given to applicants who are siblings of former students
- Fourth Priority will be given to applicants who are children of a former student
- Fifth Priority will be given to applicants who are children of Board employees
- Sixth Priority will be given to all other applicants



In Conclusion

We believe in the Four Cornerstones of a balanced education. We strongly encourage each student to take full advantage of the opportunities; academic, sporting, cultural, and leadership with service that are offered at Kerikeri High School.

We look forward to having you and your child as a part of our School community and we look forward to a positive partnership with your whānau.

Mike Clent
Principal

B.Ph.Ed., B.A., P.G.Dip.S.Mgmt, Dip.Tchg

Kerikeri High School
Hone Heke Road, Kerikeri 0230
Bay of Islands, Northland, New Zealand

PO Box 92, Kerikeri 0245
Northland, New Zealand

Telephone +64 9 407 8916
enquiries@kerikerihigh.ac.nz
www.kerikerihigh.ac.nz

